

Water Heaters

- Exclusive Rheemglas tank lining resists corrosion and prolongs tank life
- Anode rod equalizes aggressive water action
- Patented R-Foam insulation process for superior heat retention
- Isolated tank design reduces heat loss
- Certain models meet HUD Manufactured Home Construction and Safety Standards, ASHRAE 90A-80 and National Appliance Energy Conservation Act (NAECA) requirements
- Certain gas models have field convertible controls for natural or LP operation
- Relief Valve include with all models



Stock #	U.S. GAL.	# of Elements	Volts	Weight	Conn.	Height Inches	Dia.	Watts/ BTU
---------	-----------	---------------	-------	--------	-------	---------------	------	------------

One Year Warranty - HUD approved								
ELECTRIC								
0431705	30	2	240	70	Side	45-1/2"	17-3/4"	3500
0431739	30	2	240	91	Side	30"	21-3/4"	4500
0431738	30	1	120	91	Side	30"	21-3/4"	1700
0431712	40	2	240	94	Top	46-1/2"	19-3/4"	4500
0431714	40	2	240	94	Side	46-1/4"	19-3/4"	4500
0431711	40	2	240	94	Side	46-1/4"	19-3/4"	3500
0431718	50	2	240	105	Top	57"	19"	4500

Six Year Warranty								
ELECTRIC								
0431703	20	1	120	69	Side	25-1/4"	19-3/4"	1500
0431706*	30	2	240	70	Side	45-1/2"	17-3/4"	4500
0431708	30	2	240	83	Top	30"	22-1/4"	4500
0431740	30	2	240	91	Side	30"	21-3/4"	4500
0431710	30	1	120	83	Top	30"	22-1/4"	1500
0431741	30	1	120	83	Side	30"	21-3/4"	1500
0431742*	30	1	240	70	Side	45-1/2"	17-3/4"	3500
0431743*	40	1	240	94	Side	46-1/4"	19-3/4"	3500
0431717	38	2	240	108	Top	31-1/2"	23"	4500
0431715*	40	2	240	94	Side	46-1/4"	19-3/4"	4500
0431735	40	2	240	95	Top	46-1/2"	19-3/4"	4500
0431719	50	2	240	117	Top	46"	21-3/4"	4500

*HUD approved (5 year warranty).

Five Year Warranty - HUD approved								
NATURAL GAS SEALED COMBUSTION DIRECT VENT								
0431724	30	n/a	n/a	110	Side/Top	57"	17-3/4"	30,000
0431726	40	n/a	n/a	125	Side/Top	57-1/2"	19-3/4"	30,000

Five Year Warranty - HUD approved								
NATURAL								
0431721	29	3" VENT		100	Side/Top	59-3/4"	16-1/8"	30,000
0431723	40	3" VENT		120	Top/Top	61-3/4"	18-1/8"	32,000

Vent Packages

for Propane Gas Sealed
Combustion Water Heaters

- 0431748** 12"
- 0431749** 17" - 32"
- 0431750** 32" - 60"
- 0237958** Ceiling Ring



Screw-In Immersion

1" NPT no-taper screw plug. Fits many models of Rheem, State, Ruud, Norge and others. Includes one gasket.

- 0431600** 1750W-120V; 25/Ctn.
- 0431601** 1500W-120V; 25/Ctn.
- 0431602** 4500W-240V; 50/Ctn.
- 0431603** 3500W-240V; 50/Ctn.
- 0431604** 2000W-120V; 25/Ctn.
- 0431607** 3000W-240V; 12/Ctn.



Square Flange

2-1/2" square, flat surface, 2-1/2" bolt circle, 1-49/64" bolt centers. Includes one gasket. 50/Ctn.

- 0430702** 1500W-120V; 50/Ctn.
- 0430703** 4500W-240V; 25/Ctn.



Universal Flange

2-1/2" square flange with raised corners. 2-1/2" bolt circle, 1-49/64" bolt centers. Includes one regular "O" ring. 25/Ctn.

- 0431201** 1500W-120V
- 0431204** 3500W-240V
- 0431203** 4500W-240V



Open Coil Elements

Seven porcelain discs. Stainless steel rod withstands 1300° constant temperature, and the machine-twisted terminal loops insure against burnouts. 50/Ctn.

- 0430503** 1500W-120V
- 0430504** 2000W-240V
- 0430502** 1750W-120V



Gas Valve

Convertible gas valve for mobile home heaters. 1-1/2" shank.

- 0430415** Sealed Combustion
- 0430416** Atmospheric

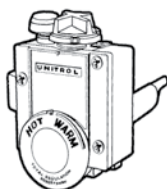

Telescoping Gas Stack and Flue Pipe

Overall length:
22-7/8" with flue pipe
NOT extended.

For use with propane gas water heaters. Pulls air from inside of home and vents exhaust out of top of home. Flange has 12° angle for sloped roofs. Extends 8-3/4" above roof line.

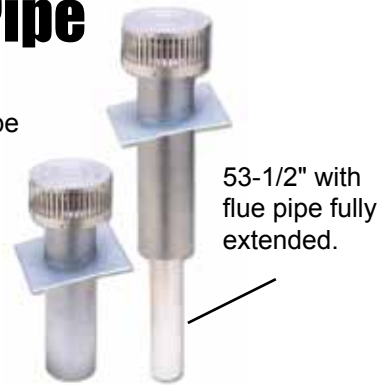

53-1/2" with flue pipe fully extended.

- 0425195** 4/Ctn.

Universal Adapter Kit

Converts screw-in element to replace round head, flat flange and universal flange. 12/Ctn.

- 0430604**

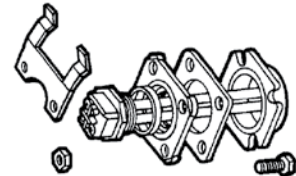

T & P Valve

Temperature and pressure relief valve with test lever, stainless steel spring and all bronze body. Thermostat is positive, accurate and proven. Self-closing. 50/Ctn.

- 0430120** 3/4" x 4" L
- 0432048** 3/4" x 5" L
- 0432046** 1/2" x 4" L



Water Heater Door

Without Vents

- 0212000** 22" x 60"
- 0211997** 23" x 60"

With Vents
(Not Shown)

- 0432050** 22" x 60"
- 0211999** 23" x 60"

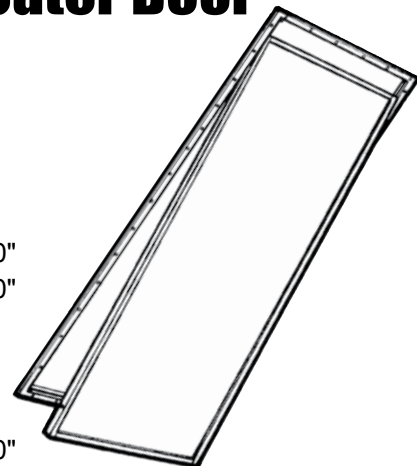

Flexible Water Connectors

Flexible copper connector
for water only.

0440015 24"; 25/Ctn.

0440010 18"; 25/Ctn.

0440018 Washer



Flexible Gas Connectors

1/2" OD coated brass tubing 1/2" FPT x 1/2"
MPT (tapped 3/8" FPT). Approved for indoor
and outdoor use. AGA listed.

0250815 18"

0250816 24"

0250817 36"

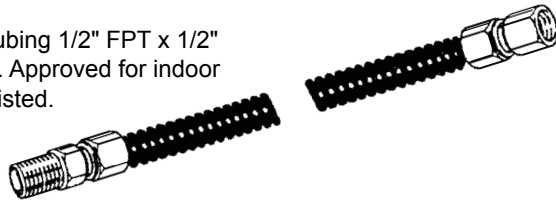

PEX Water Heater Swivel Connectors

3/4" insert x 3/4" FPT for PEX
tubing & pipe.

0440017

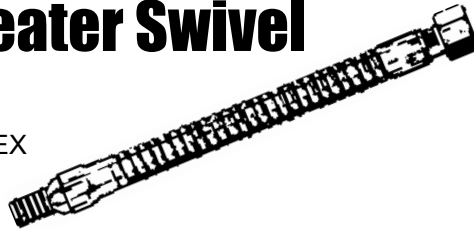

Shark Bite Push-On Water Heater Connector

0440012 3/4" FIP x 3/4" shark bite x 24" long

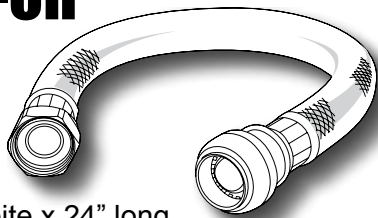

Waterway Connector

For water heater inlet and outlet hookup plus
other uses, where dissimilar metals occur in
piping and plumbing systems. 3/4" MPT x 3/4"
MPT x 3" length MIP. Thermoplastic lining
prevents corrosion. Bulk.

0431625



Drip Pan

Plastic polymer, semi-flexible.
Pre-drilled to accept furnished
1" PVC plastic fitting. Meets
requirement of Southern
Building Code.

0260155 22"; 12/Ctn.

0260156 24"; 12/Ctn.



Drain Tool



0380150

Water Heater Insulation

Vinyl-backed Fiberglass
Insulation is designed for
gas, oil, and electric water
heaters up to 60-gallon
capacity. Available in a
choice of thicknesses to
offer you greater R-values.

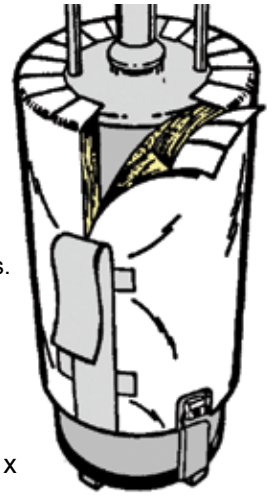

0270500 2" thick x 48"
x75" R6.7

0270501 3" thick x 48" x
75" R10

Water Heater Thermocouple

Fully universal. Fits push-in,
screw-in or clamp-on type pilot
burners. 24/Ctn.

0232501 18"

0232502 24"

0232503 30"



Continuity Tester

Tests elements and thermostats
while they are in the water heater.
LED light indicates continuity.
Unbreakable body with protective
covers over light and probe.

0382006 12/Ctn.



T-stat

Replacement for any electric,
domestic water heater.

0431901 Double-throw 240V

0431904 Thermo Disc 1-Pole

0431906 Lower Thermostat.

